



LAYOUT DIAGRAM (原理图): (FIG-1)

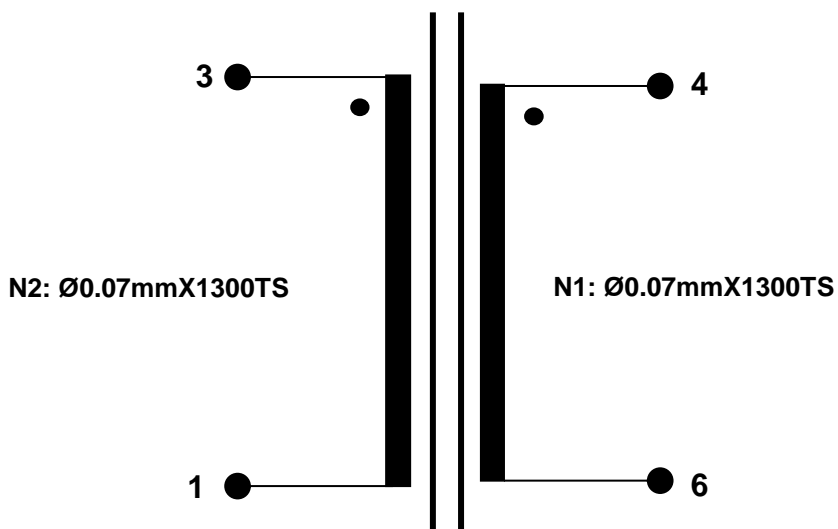

FIG-1

CROSS SECTION DAGRAM剖视图: (FIG-2)

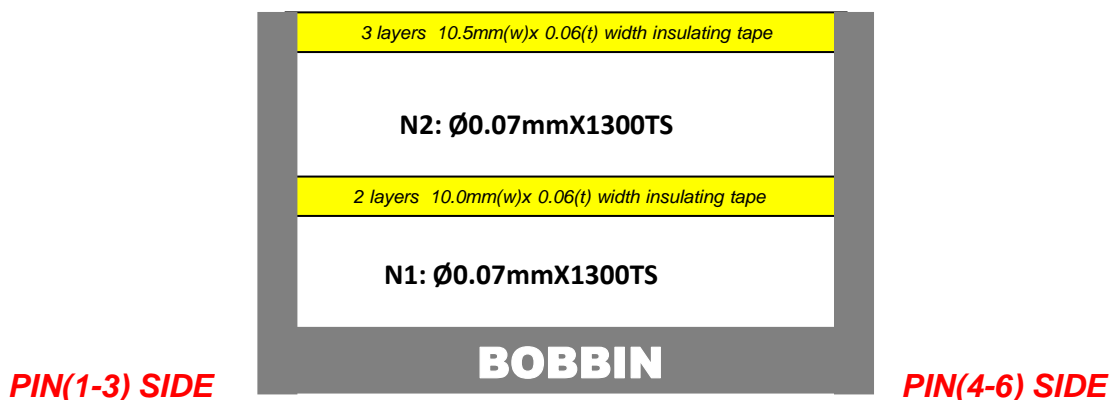

FIG-2

Prepared By:	Date:	TITLE: TRANSFORMER	CUSTOMER	MODEL NO:EE16	
Checked By:	Date:		Approved:	REV.	00
Approved By:	Date:		Date:	PAGE 1 OF 3	



Data Specification(特性要求) : (Table-2)

ITEM 項目	MEASUREMENTS 测试脚位	CHARACTERISTICS 测试範圍	MEASURING CONDITIONS 测试條件 T=25±3°C;HR(%)=45±15	REMARK 備注
L 電感	PIN(3-1)	9.0H MIN.	F(kHz)=1 Ug(V)=1	SERIAL MODE 串联模式
	PIN(4-6)	9.0H MIN.	F(kHz)=1 Ug(V)=1	SERIAL MODE 串联模式
DCR 电阻	PIN(3-1)	250Ω MAX	/	4 WIRE MODEL 四线模式
	PIN(4-6)	210Ω MAX	/	4 WIRE MODEL 四线模式
HIPOT 耐壓	PRI./SEC.	NO Breakdown 漏电流≤5.0mA	VDC=600V/1SEC. F(Hz)=50	/
	COIL/CORE	NO Breakdown 漏电流≤5.0mA	VDC=600V/1SEC. F(Hz)=50	/
PH 相位	REFER TO LAYOUT DIAGRAM FIG-1 參考原理圖(FIG-1)			

Prepared By :	Date:	TITLE: TRANSFORMER	CUSTOMER	MODEL NO:EE16	
Checked By :	Date:		Approved:	REV.	00
Approved By :	Date:		Date:	PAGE 2 OF 3	



OUTLINE DIAGRAM (外观图) : (FIG-3 FIG-4 FIG-5 FIG-6)

UNIT : mm

Tolerance unless otherwise specified: .X±0.5 .XX±0.1

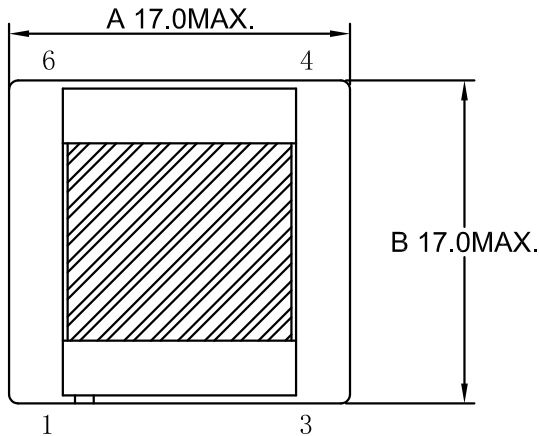

FIG-3

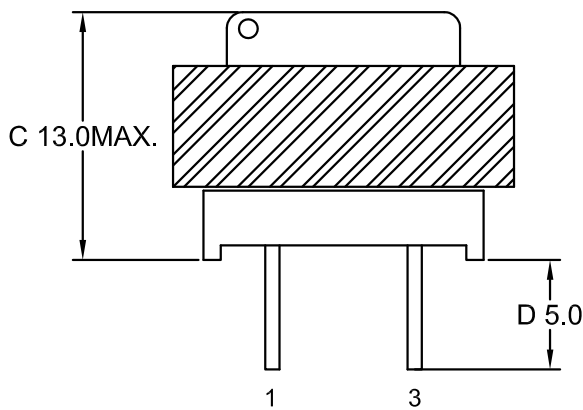

FIG-4

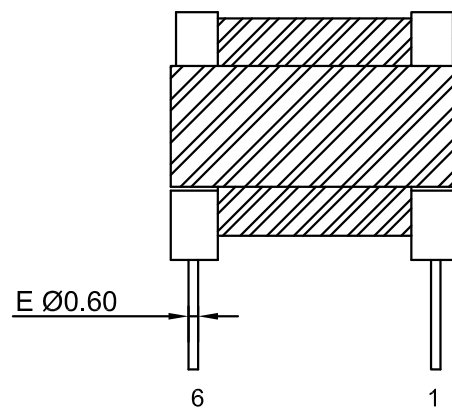

FIG-6

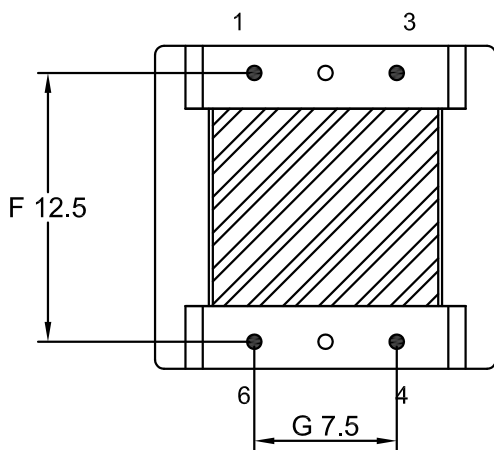

FIG-5

NOTE:

1. The bobbin must remove pin2&5;
Bobbin需拔掉2&5;
2. Assembly the 2 magnetic cores on the bobbin with 2 layers 5.0mm width tape;
用2层5.0mm宽的胶带将两铁芯组装在胶芯上;
3. The transformer must be vacuum impregnated in varnish #642;
产品需含浸凡立水#642且抽真空;
4. YYWW: year and week code (FIG-4).
YYWW: 年份周期代码 (FIG-4).
5. All parts should be complied with RoHS .
产品须满足RoHS需求.

Prepared By :	Date :	TITLE : TRANSFORMER	CUSTOMER Approved: Date:	MODEL NO. :EE16		
Checked By :	Date :			REV. :	00	
Approved By :	Date :			PAGE 3 OF 3		